



- 4 bedroom large semi detached
- Grade II listed
- Versatile throughout
- Some original features

2 Terrace Road, Newport, PO30 1EE

£350,000

Situated within Newport this 4 bedroom Grade II listed home offers versatile accommodation throughout its three levels.. Many of the original features have been retained and offer lovely points of interest in each room. A fabulous home with great potential throughout. Offered as CHAIN FREE.



Property Description

THE ACCOMMODATION WITH APPROXIMATE MEASUREMENTS

DOOR TO

HALLWAY

Stairs to first floor. Under stairs storage cupboard. (Electric meter) Doors to:

LOUNGE/DINER

23' 6 " x 15' 04" (7.16m x 4.67m) Two sash windows to front aspect. One sash window to rear aspect. Original feature fireplace. Two radiators.

BATHROOM

7' 09" x 5' 0" (2.36m x 1.52m) Hand basin. Bath with electric shower over. WC.

KITCHEN

11' 7" x 10' 7" (3.53m x 3.23m) A selection of wall and base units. Butler sink. Rayburn cooker. Radiator. Door and window to side aspect and garden.

UTILITY ROOM

Door to back garden. Glow Worm Flexicom gas boiler. Water meter. Selection of storage units.

STAIRS TO FIRST FLOOR

BEDROOM

15' 9" x 11' 1" (4.8m x 3.38m) Two sash windows. Radiator. Built in cupboard.

BEDROOM

12' 7" x 9' 9" (3.84m x 2.97m) Sash window. Radiator. Built in cupboard.





LANDING

Airing cupboard with cylinder. Additional storage area.

BATHROOM

10' 4" x 8' 10" (3.15m x 2.69m) Sash window. Hand basin. WC. Bath with shower over. Fireplace. Radiator.

STAIRS TO SECOND FLOOR

BEDROOM

14' 7" x 11' 2" (4.44m x 3.4m) Two sash windows. Radiator. Fireplace. Built in cupboard.

BEDROOM

12' 6" x 9' 10" (3.81m x 3m) Window. Radiator. Fireplace. Built in cupboard.



OUTSIDE

FRONT: Gate to front garden. Feature veranda. Open porch. Mature shrubs and plants.

REAR: Mainly laid to slab. Some shrubs.



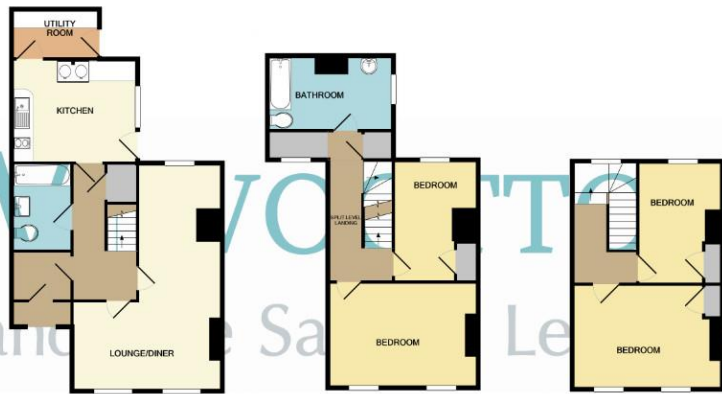

GROUND FLOOR APPROX. FLOOR AREA 620 SQ.FT. (57.5 SQ.M.)
 1ST FLOOR APPROX. FLOOR AREA 467 SQ.FT. (43.4 SQ.M.)
 2ND FLOOR APPROX. FLOOR AREA 311 SQ.FT. (28.7 SQ.M.)

TOTAL APPROX. FLOOR AREA 1437 SQ.FT. (133.5 SQ.M.)

Whilst every attempt has been made to ensure the accuracy of the floor plan contained here, measurements of doors, windows, rooms and any other items are approximate and no responsibility is taken for any error, omission, or mis-statement. This plan is for illustrative purposes only and should be used as such by any prospective purchaser. The services, systems and appliances shown have not been tested and no guarantee as to their operability or efficiency can be given.
 Made with Metropix ©2021



Do you have a property to sell? We would welcome the opportunity to give you a free no obligation valuation of your home. Just ask!

41 High Street, Wootton Bridge,
 Isle Of Wight, PO33 4LU

www.woottonestateagents.co.uk
 01983 883333
sales@woottonestateagents.com

All measurements are approximate and should not be taken as fact. Wootton Estate agents have not tested any of the appliances or equipment. We have been advised by the vendor as to the leasehold/freehold status of the property, you should have this along with all matters concerning the property checked by a solicitor. These particulars including all text and pictures are for guidance only and do not form any part of a contract or offer and should be not construed as statements of fact. Floor plans are for guidance only and no guarantee is given of their accuracy. Averages and land measurement are not measured by Wootton Estates and should be independently checked.